

**VALVOLA A SFERA MANUALE A 2 VIE A 2 PEZZI
IN ACCIAIO INOX 316
AISI 316 STAINLESS STEEL 2 WAYS MANUAL BALL
VALVE 2 PCS DESIGN**



SERIES V10



CARATTERISTICHE

1. Valvola a Sfera a 2 vie a Passaggio Totale in Acciaio Inox
2. Filettate gas (DIN 2999), filettate NPT (ANSI B 2.1)
3. Costruita in Acciaio Inox AISI 316 (CF8M)
4. Seggi in PTFE + 15% Fibra di vetro
5. O Ring stelo in Viton
6. Boccola stelo PTFE
7. Sistema di bloccaggio
8. Sistema di Antiespulsione
9. Pressione di esercizio: max 63 Kg/cm² fino a 45°C;
per temperature superiori vedere diagramma
10. Temperatura di esercizio: - 25 °C +180 °C

FEATURES

1. 2 way Stainless steel full port ball valve, 2 pieces
2. Available Ends: GAS thread (DIN 2999), NPT thread (ANSI B 2.1)
3. Made in AISI 316 (CF8M)
4. Ball seats PTFE + 15 % G.F.
5. Viton O Ring stem
6. Stem gasket PTFE
7. Locking system
8. Blow-out proof stem
9. Working pressure: max 63 Kg/cm² up to 45°C;
for higher temperature refer to diagram
10. Working Temperature: - 25 °C +180 °C

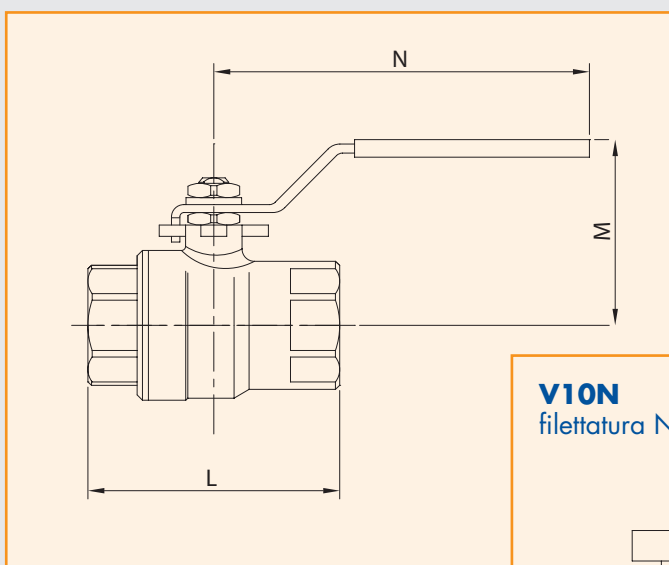

V10N
filettatura NPT - NPT thread

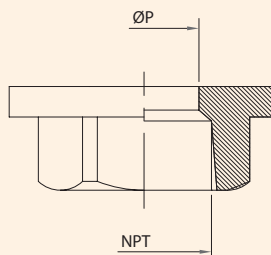

V10G
filettatura GAS - GAS thread

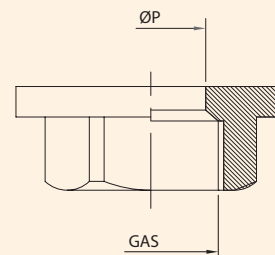

DIMENSIONI / DIMENSIONS

Ref. Code (*)	Size	DN (mm)	PN (kg/cm ²)	P	M (mm)	L (mm)	N (mm)	Weigth (kg)
PV02-V10*M14	1/4"	8	63	11	50	50	104	0.21
PV02-V10*I38	3/8"	10	63	12.7	50	50	104	0.20
PV02-V10*A12	1/2"	15	63	15	51.5	55	104	0.24
PV02-V10*B34	3/4"	20	63	20	62	70	122	0.44
PV02-V10*C10	1"	25	63	25	65	83	122	0.61
PV02-V10*D13	1 1/4"	32	63	32	82	91	180	1.08
PV02-V10*E15	1 1/2"	40	63	40	88	103	205	1.54
PV02-V10*F20	2"	50	63	50	106	120	219	2.65
PV02-V10*G25	2 1/2"	65	63	65	119	152	230	4.71
PV02-V10*H30	3"	80	63	80	135	172	275	7.29

(*) to complete the code, replace * with G=Gas; N=NPT

ESPLOSO EXPLODED VIEW



DIAGRAMMA PRESSIONE – TEMPERATURA
PRESSURE – TEMPERATURE CHART



DIAGRAMMA PERDITE DI CARICO
PRESSURE DROP CHART

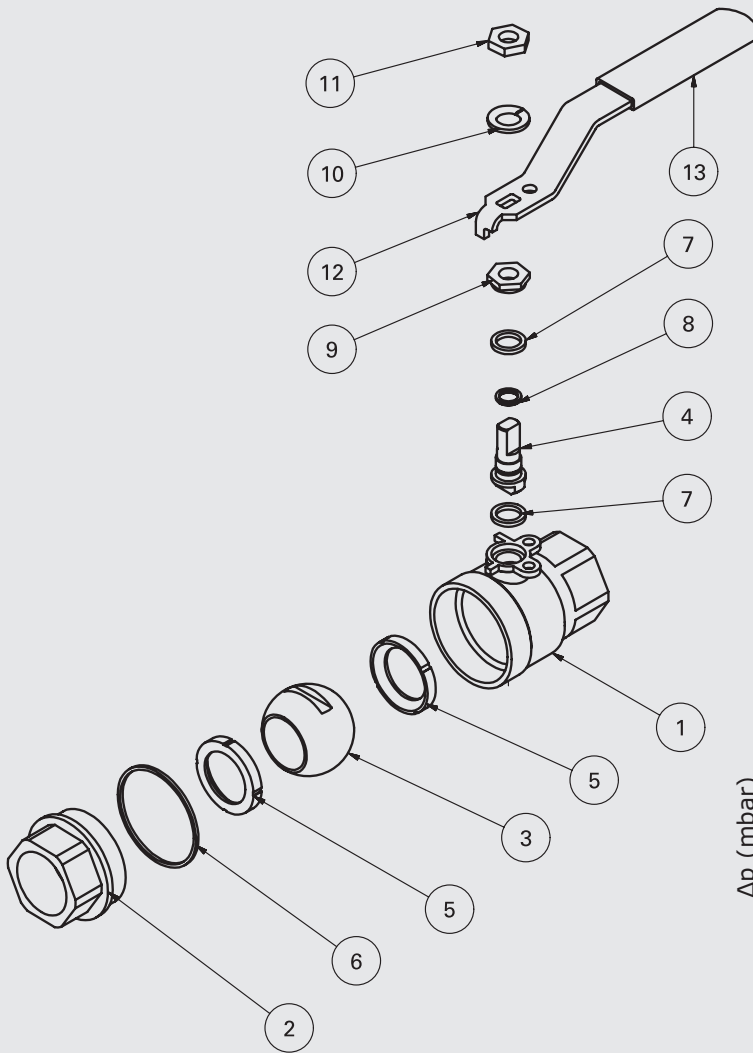
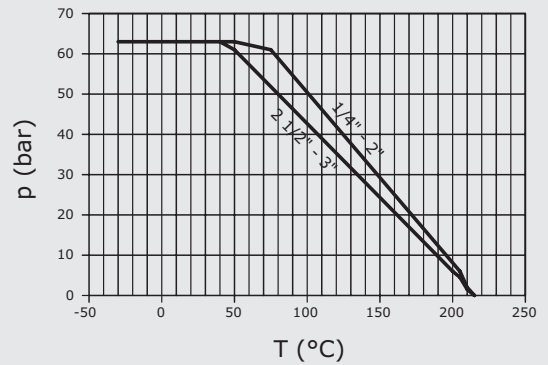
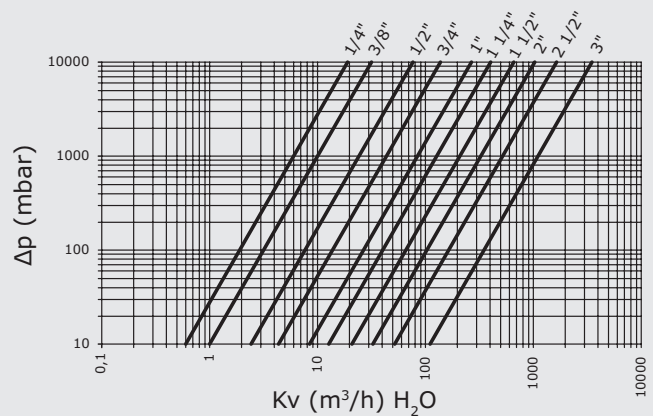

MATERIALI / MATERIALS

N°	Articolo	Material	Item
1	Corpo	DIN 1.4408 (ASTM A351 CF8M, SS 316)	Body
2	Chiusura	DIN 1.4408 (ASTM A351 CF8M, SS 316)	Cap
3	Sfera	DIN 1.4408 (ASTM A351 CF8M, SS 316)	Ball
4	Stelo	DIN 1.4401 (AISI 316)	Stem
5	Seggio Sfera	PTFE + 15% G.F.	Ball seats
6	Guarnizione	PTFE	Gasket
7	Rondella Anti frizione	PTFE	Trust Washer
8	O Ring	VITON	O-ring
9	Blocco Stelo	DIN 1.4301 (AISI 304)	Stem Packing
10	Rondella Anti Svitamento	DIN 1.4301 (AISI 304)	Washer
11	Dado	DIN 1.4301 (AISI 304)	Nut
12	Maniglia	DIN 1.4301 (AISI 304)	Handle
13	Rivestimento Maniglia	Vynil	Handle Sleeve